

• ELEVATION ON SIXTH ST •

• SOUTH ELEVATION •

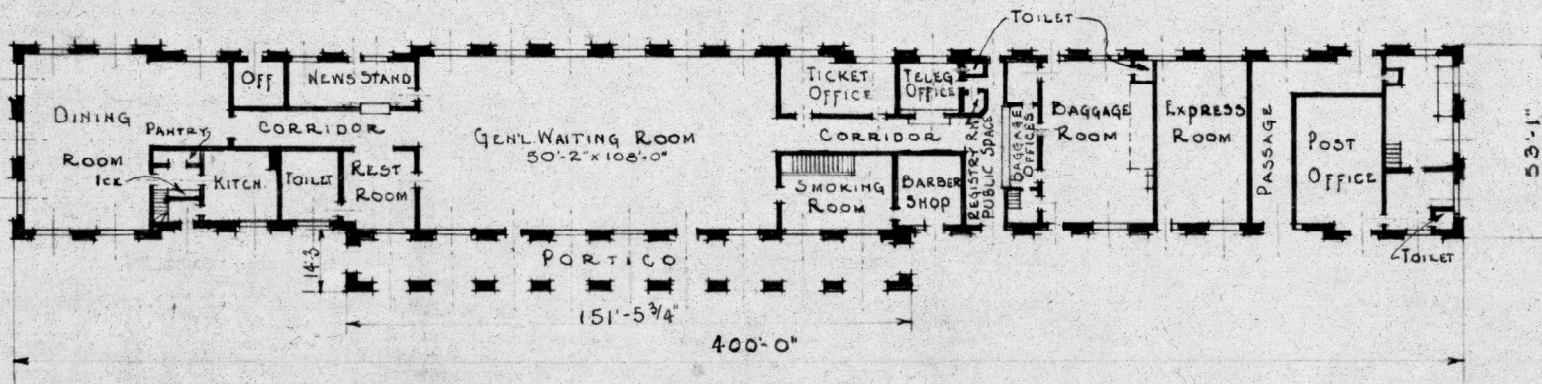

• FIRST FLOOR PLAN •

FOUNDATION - CONCRETE.  
 EXTERIOR FINISH - BRICK WITH SANDSTONE TRIM.  
 INTERIOR FINISH - TILE FLOOR IN WTG. RM. DINING ROOM & CORRIDORS, TOILETS & BARBER SHOP. BAGGAGE ROOM FLOOR IS CONC. ALL OTHER ARE OF WOOD. CEILINGS IN WAITING & DINING RMs. ARE WOOD PANELED. OTHERS ARE CORRUGATED METAL. ALL WALLS ARE PLASTERED.  
 SHEET METAL - GUTTERS, DOWNSPOUTS ARE W.I.  
 TOWER IS COPPER COVERED.  
 ROOF - SLATE ROOF WITH TIN DECK.  
 DATE BUILT - 1895.  
 TOTAL SQ. FT. - 21,200.  
 TOTAL CU. FT. - 826,800.

CEILING HEIGHT - 30'-0" IN WAITING RM.

C. B. & Q. R. R.  
 ST. JOSEPH DIVISION  
 ST. JOSEPH MISSOURI  
 PASSENGER STATION  
 SCALE 1" = 50' NOV. 22, 1928.  
 REDUCED FROM DRWG. # 59915.  
 ENGINEER OF BUILDINGS.  
 B. W. C.