

TRACKSIDE ELEVATION

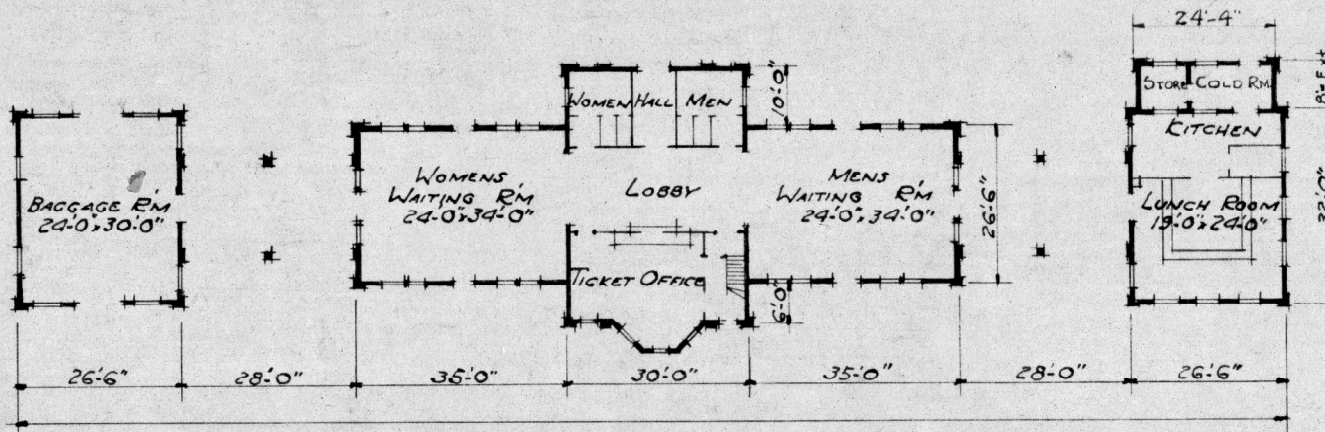

FLOOR PLAN

Note: 8'-0" Extension Under 1926 A.F.E. #16163.

Foundation - Concrete
 Exterior walls - Brick
 Interior walls and ceiling - Plaster, Waiting Rms. & Toilets Enam. Brick Wainscot.
 Floors - Waiting Rm. & Toilets Tile floor & Base.
 Ticket Office - Wood
 Baggage Rm. - Brick
 Lunch Rm. - Tile
 2nd Story Maple.

Ceiling Height - Waiting Room 12'-2"
 Second Floor 9'-4"

Roof - Slate.
 Date Built. 1912.

Area.
 Main Bldg. 4405[±]
 Lunch & Baggage Rm. 1696[±]
 Canopies 924[±]

Contents: Extension 224[±] at 18'-3" = 4,088 Cu.Ft.
 Main Building. 2550[±] at 27'-High = 68,850 Cu.Ft.
 1855[±] at 18'-3" High = 33,854 Cu.Ft.
 Lunch Room. 844[±] at 18'-3" High = 15,476 Cu.Ft.
 Baggage Rm. 844[±] at 18'-3" High = 15,476 Cu.Ft.
 Total Contents = 137,744 Cu.Ft.

Heating: 1- 4'x16' Kewanee Boiler } in Pump House
 1- 4'x14' Frost " }

Radiation: 1685 sq. ft.

C. B. & Q. R. R.
 LA CROSSE DIVISION
 SAVANNA ILLINOIS
 PASSENGER STATION
 SCALE 1"=30' FEB.-12-1924
 REDUCED FROM DRWG. NO 32042⁵/₈
 OFFICE OF ENGINEER OF BUILDINGS